

SCHOOL INFORMATION PROFILE

Name of School: SCITS

Updated: 2016 03 31

Page 1

Facility Profile

- Site plan and floor plan(s) (or space template) of the school with the date of school construction and any subsequent additions.
Date of construction and subsequent additions: 1922, 1960, 1962, 1966, 1968
(Attached)
- School attendance area (boundary) Map is attached
- Context map (or air photo) of the school indicating the existing land uses surrounding the school.
(Attached)
- Planning map of the school with zoning, Official Plan or secondary plan land use designations.
(Attached)
- Legal Description 2008-Plan 5 PT Lot 2 PT Lot 3 PT Lot 4 Pt Lot 5 Plan 33 Lot 1-8
- Size of the school site (acres or hectares)
3.73 HA
9.21683 Acres
- Building area (square feet or square metres).
16,289 sq.m.
175,339 sq.ft.
- Number of portable classrooms.
0
- Number and type of instructional rooms as well as specialized classroom teaching spaces (e.g., science lab, tech shop, gymnasium, etc.).
6 science labs, a library, a cafeteria, a track shed, and **44** classrooms including
 - a grade nine integrated technologies room
 - a construction technology room
 - a transportation technology room
 - a manufacturing technology room
 - 2 art rooms
 - 2 music rooms
 - a weight room
 - a wrestling room
 - a double gymnasium
 - a single gymnasium
 - a foods lab – **5 full stations**
 - a fashion lab
 - a FN Support Room
 - a swimming pool
 - a Special Needs Classroom
 - **a green room (Drama)**
 - **an auditorium**
 - **classrooms are air conditioned**
 - **currently nine shuttered classrooms**
- Area of hard surfaced outdoor play area and/or green space, the number of play fields, and the presence of outdoor facilities (e.g., tracks, courts for basketball, tennis, etc.).
 - Park/gazebo area on the northwest corner (25,650 sq.ft.)

SCHOOL INFORMATION PROFILE

Name of School: SCITS

Updated: 2016 03 31

Page 2

•	An irrigated soccer/football field (128,930 sq.ft.)																								
○	<p>Ten-year history of major facility improvements (item and cost).</p> <p>2005 – Fire Alarm Upgrade \$250,415 2008 – Plaster Ceiling Replacement \$174,293 2009 – Partial Roof Replacement \$418,207 2010 – Partial Roof Replacement \$300,294 2011 – Domestic Water Heater Upgrade \$261,019 2011 – Partial Window Replacement \$169,137 2012 – Access Control & CCTV \$100,000 2013 – Lighting Upgrade (Library) \$21,800 2014 – Building Envelope Improvements (caulking) \$35,304 2015 – Partial Roof Replacement \$151,115</p>																								
○	<p>Projected five-year facility renewal needs of school (item and cost). (Attached)</p>																								
○	<p>Current Facility Condition Index (FCI) with a definition of what the index represents. FCI: 59.91% Total cost of facility work (2015-2024): \$17 695 459 Facility replacement value: \$30 m Substructure and shell: \$1 339 601 Interiors: \$3 689 542 Services: \$9 299 432 Special construction and site work: \$3 366 884</p>																								
○	<p>Student Distance to school</p> <table border="1" style="margin-left: 20px; border-collapse: collapse; text-align: center;"> <thead> <tr style="background-color: #d3d3d3;"> <th colspan="3">Distance (KMs)</th> </tr> <tr style="background-color: #d3d3d3;"> <th>Minimum</th> <th>Maximum</th> <th>Average</th> </tr> </thead> <tbody> <tr> <td>0.09</td> <td>28.58</td> <td>6.37</td> </tr> </tbody> </table>	Distance (KMs)			Minimum	Maximum	Average	0.09	28.58	6.37															
Distance (KMs)																									
Minimum	Maximum	Average																							
0.09	28.58	6.37																							
○	<p>Student eligibility percentage with morning and afternoon ride times in minutes</p> <table border="1" style="margin-left: 20px; border-collapse: collapse; text-align: center;"> <thead> <tr style="background-color: #d3d3d3;"> <th colspan="2">Students</th> <th colspan="3">Morning Ride (Minutes)</th> <th colspan="3">Afternoon Ride (Minutes)</th> </tr> <tr style="background-color: #d3d3d3;"> <th>Percent Eligible</th> <th>Percent Not Bused</th> <th>Minimum</th> <th>Maximum</th> <th>Average</th> <th>Minimum</th> <th>Maximum</th> <th>Average</th> </tr> </thead> <tbody> <tr> <td>41.8%</td> <td>58.2%</td> <td>3</td> <td>40</td> <td>19.36</td> <td>3</td> <td>63</td> <td>28.01</td> </tr> </tbody> </table>	Students		Morning Ride (Minutes)			Afternoon Ride (Minutes)			Percent Eligible	Percent Not Bused	Minimum	Maximum	Average	Minimum	Maximum	Average	41.8%	58.2%	3	40	19.36	3	63	28.01
Students		Morning Ride (Minutes)			Afternoon Ride (Minutes)																				
Percent Eligible	Percent Not Bused	Minimum	Maximum	Average	Minimum	Maximum	Average																		
41.8%	58.2%	3	40	19.36	3	63	28.01																		
○	<p>School utility costs (totals, per square foot, and per student). Total 2015 Utility Cost is \$324,333</p>																								

SCHOOL INFORMATION PROFILE

Name of School: SCITS

Updated: 2016 03 31

Page 3

- Number of parking spaces on site at the school, an assessment of the adequacy of parking, and bus/car access and egress.
East lot has 58 parking spaces. West lot has 30 parking spaces. Total of 88 spaces.
Currently, 64 of the 88 spaces are used for staff parking, leaving only 24 spaces for student and visitor parking.
Both parking lots require the remarking of lines and numbers.
The parking or paved driving space available is inadequate for the amount of traffic generated by bus use, parent and student drivers, visitor parking etc. **during peak times.**
There is insufficient parking during scheduled events (Parents' Night, SCITS Revue, tournaments, etc.)
There is only one designated handicapped parking spot.
- Measures that the school board has identified and/or addressed for accessibility of the school for students, staff, and the public with disabilities (i.e., barrier-free).
A number of areas of the building are not accessible. Specifically the stage and balcony, the library, the pool area and the small gym.
The only automatic door is the west external door ramp. This is a considerable distance from the Gym area and the Cafeteria.
There is a functional elevator located on the first floor, serving second and third floors, that is accessible from the east door where there is a ramp from the parking lot. There are three steps up to the first floor elevator level from the front door, and steps from the west parking lot to the west door. From the back of the building, two south doors are level entries, but the back addition is at a lower level than the first floor of the original building. There is a ramp from the tech addition up to the first floor just outside Room 121.
The accessible washrooms are on the 2nd floor (easier access from the auditorium).
There is no elevator or wheelchair access to the Library, Gym C, the pool, or the change rooms that serve these facilities.
- On-the-ground (OTG) capacity, and surplus/shortage of pupil places 564.5/1050
On-the-ground (OTG) capacity: 1050
October 31, 2015 enrolment: 564.5
Capacity utilization: 54%

SCHOOL INFORMATION PROFILE

Name of School: SCITS

Updated: 2016 03 31

Page 4

Instructional Profile

- o Describe the number and type of teaching staff, non-teaching staff, support staff, itinerant staff, and administrative staff at the school.

SCITS staff

38 teaching staff and 35.83 FTE teaching staff

1 principal and 1 vice-principal

1 office supervisor, 1 12 month clerk, 1 10 month clerk

1 library supervisor and 1 half-time library clerk

1 Educational Assistant

8 custodians

First Nations cultural worker

Non-LKDSB staff

Aamjiwnaang cultural worker

2 cafeteria workers

LKDSB staff at SCITS

5 Program Department staff

- o Describe the course and program offerings at the school.

Grade 9-12, academic/applied, university/college/workplace preparation

eLearning and blended learning

Visual arts, instrumental (brass/wood wind) music, vocal music, drama

Foods, fashion

Technology: communication, computer engineering, construction, design, manufacturing, transportation

Specialist High Skill Major: Arts and Culture

PEOPEL Program

Ojibwe language and Native studies

Special Education – Resource teacher, Special Needs Class

Student Success

- o Describe the specialized service offerings at the school (e.g., cooperative placements, guidance counseling, etc.).

Guidance counseling

Co-operative education

Ontario Youth Apprenticeship Program (OYAP)

Dual Credits through Lambton College

Breakfast program

Psychology services

Sexual health services

SCHOOL INFORMATION PROFILE

Name of School: SCITS

Updated: 2016 03 31

Page 5

<ul style="list-style-type: none"> ○ Current grade configuration of the school (e.g., junior kindergarten to Grade 6, junior kindergarten to Grade 12, etc.). Grades 9-12
<ul style="list-style-type: none"> ○ Current grade organization of the school (e.g., number of combined grades, etc.). There are ~34 combined courses.
<ul style="list-style-type: none"> ○ Number of out of area students. 80
<ul style="list-style-type: none"> ○ Utilization factor/classroom usage. Capacity utilization: 54% 9 classrooms have been taken out of service
<ul style="list-style-type: none"> ○ Summary of five previous years' enrolment and 10-year enrolment projection by grade and program - (Attached)
<ul style="list-style-type: none"> ○ Current extracurricular activities. <ul style="list-style-type: none"> School Clubs <ul style="list-style-type: none"> ○ Art Club ○ Concert Band, Jazz Band ○ Concert Choir ○ CORE (Christian faith based group) ○ Equity and Inclusion ○ Intramurals (lunch time athletics) ○ Key Club (student service club) ○ Student Parliament (student leadership) School Athletics <ul style="list-style-type: none"> ○ Badminton ○ Basketball ○ Baseball ○ Cross Country ○ Football ○ Golf ○ Rugby ○ Soccer ○ Tennis ○ Track and Field ○ Triathlon ○ Volleyball ○ Wrestling School Events <ul style="list-style-type: none"> ○ SCITS Revue ○ SCITStock ○ Tunes at Noon ○ Ski trip to Quebec

SCHOOL INFORMATION PROFILE

Name of School: SCITS

Updated: 2016 03 31

Page 6

- Europe trip
- Rugby trip to major U.S. city
- Math competitions
- Music nights
- Annual musical
- Awards night and graduation
- Chain of Caring
- School dances including prom

SCHOOL INFORMATION PROFILE

Name of School: SCITS

Updated: 2016 03 31

Page 7

Other School Use Profile

- Current non-school programs or services resident at or co-located with the school as well as any revenue from these non-school programs or services and whether or not it is at full cost recovery.
LKDSB Program Department Office
- Current facility partnerships as well as any revenue from the facility partnerships and whether or not it is at full cost recovery.
n/a
- Community use of the school as well as any revenue from the community use of the school and whether or not it is at full cost recovery.
- The tables below contain 2015-16 data as at January 11, 2016 from the CLASS school rental booking software. Data is a combination of historical data and projected data as follows:

September 1st 2015 – January 10th 2016 - historical data

January 11th 2016 – June 30th 2016 - projections based on current permits in the system.

PROJECTED SEPTEMBER 2015-JUNE 2016

SCHOOL RENTAL PERMITTED HOURS

Auditorium	136
Cafeteria	142
Classroom	56
Gymnasium – Double	452
Gymnasium – Single	374
Hallways (walking groups)	101
TOTAL PERMITTED HOURS	1,788

PROJECTED SEPTEMBER 2015-JUNE 2016

SCHOOL RENTAL REVENUE

Paid by rental groups	\$2,831
Covered by the CUS grant (including PSI**)	\$48,287
TOTAL REVENUE	\$51,118

**Rental fees and custodial service charges were established based on cost recovery*

***SCITS is designated as a Priority Schools Initiative (PSI) school.*

COMMUNITY USE OVERVIEW:

Four adult and seven youth groups use the gymnasium/s for volleyball, soccer and basketball as well as the Army and Air Cadets for their annual ceremonial parades. A stamp group uses the cafeteria. A wrestling club uses the wrestling room. Theatre based groups and community organizations rent the auditorium as well as a commercial dance company. A concert band uses the music room. Track group use the hallways. Other annual events:

SCHOOL INFORMATION PROFILE

Name of School: SCITS







Updated: 2016 03 31

Page 8

Sharing Smiles Community Living event, Engineers Youth Competition, Lambton County Music Festival, Kinsmen Christmas parade reception.

PRIORITY SCHOOLS INITIATIVE (PSI) OVERVIEW:

The Priority Schools Initiative, a component of Community Use of Schools is also funded by the Ministry to support schools located in communities that need it most, allowing not-for-profit groups free after-hours access to school facilities.

-  There are 220 designated 'priority schools' located in 38 Ontario school boards.
-  The designated schools are intended to be located where they can effectively address the needs of communities/neighbourhoods where socioeconomic or other barriers would otherwise hinder CUS access and programming.
-  The Ministry has designated SCITS as a 'priority school'.
-  Any requests for substitution of Priority School must be accompanied by a sound rationale and if necessary supporting documents indicating why and how a school board will continue to serve user groups of the current Priority School.
-  If a board fails to submit a request for substitution by the end of May the request will likely be held over to the following school year for review at that time.
-  Approvals of substitutions are conditional on the board providing the Ministry with satisfactory rationale that the changes meet the intent of the program.

Various community basketball, soccer and volleyball organizations use the gymnasium/s. A local stamp group uses the cafeteria. A local wrestling club uses the wrestling room. Sarnia Police Service also use the wrestling room. Various theatre based groups rent the auditorium.

- Availability of before and after school programs or services (e.g., child care) as well as any revenue from the before and after school programs and whether or not it is at full cost recovery.
n/a
- Lease terms at the school as well as any revenue from the lease and whether or not it is at full cost recovery.
n/a
- Description of the school's suitability for facility partnerships.
n/a as this would depend on input from insurance agencies.

SCHOOL INFORMATION PROFILE

Name of School: SCITS

Updated: 2016 03 31

Page 9

Existing School Boundary Areas for:
 Sarnia Collegiate Institute & Technical School (SCITS); St. Clair Secondary School (SCSS); Northern Collegiate Institute & Vocational School (NCIVS).

Existing School Boundary Areas for:

- Sarnia Collegiate Institute & Technical School (SCITS);
- St. Clair Secondary School (SCSS);
- Northern Collegiate Institute & Vocational School (NCIVS)

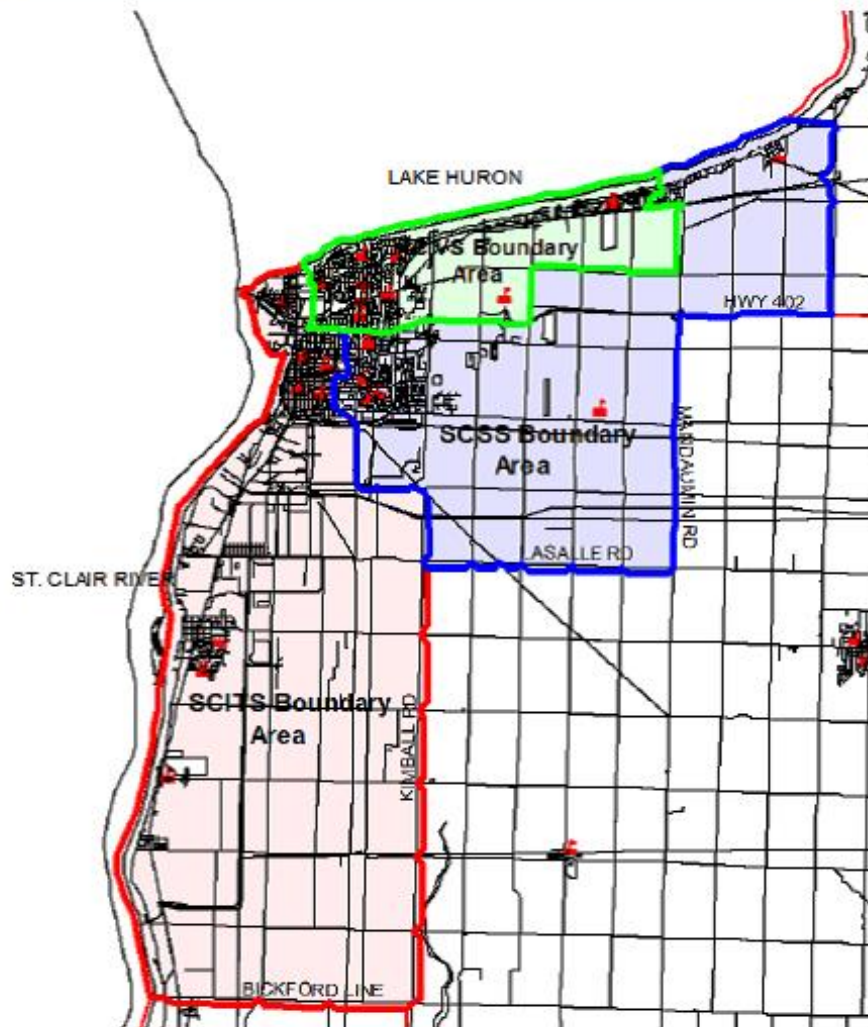

SCHOOL INFORMATION PROFILE

Name of School: SCITS

Updated: 2016 03 31

Page 10

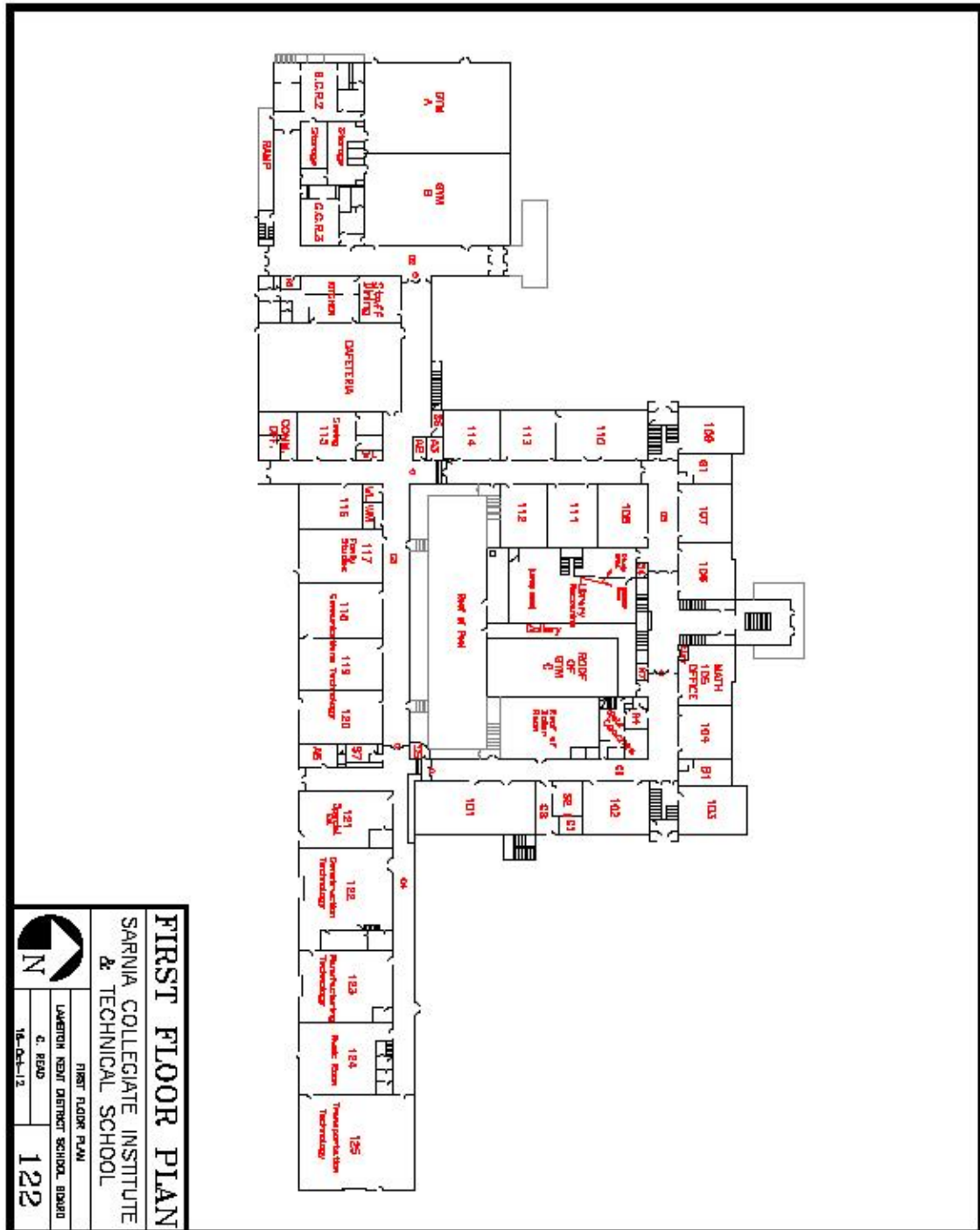

SCHOOL INFORMATION PROFILE

Name of School: SCITS

Updated: 2016 03 31

Page 11

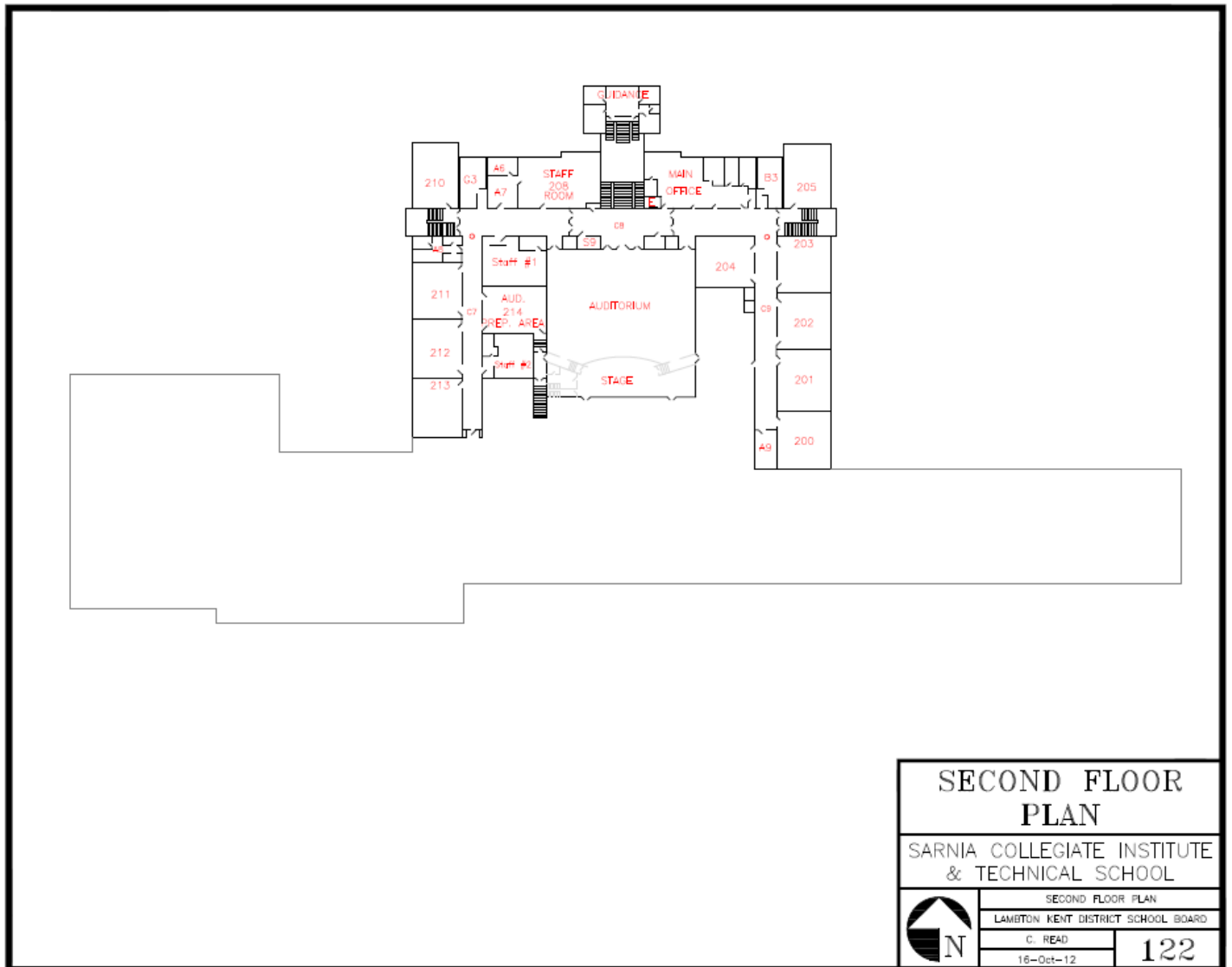

SECOND FLOOR PLAN

SARNIA COLLEGIATE INSTITUTE & TECHNICAL SCHOOL

	SECOND FLOOR PLAN	
	LAMBTON KENT DISTRICT SCHOOL BOARD	
	C. READ	122

16-Oct-12

SCHOOL INFORMATION PROFILE

Name of School: SCITS

Updated: 2016 03 31

Page 12

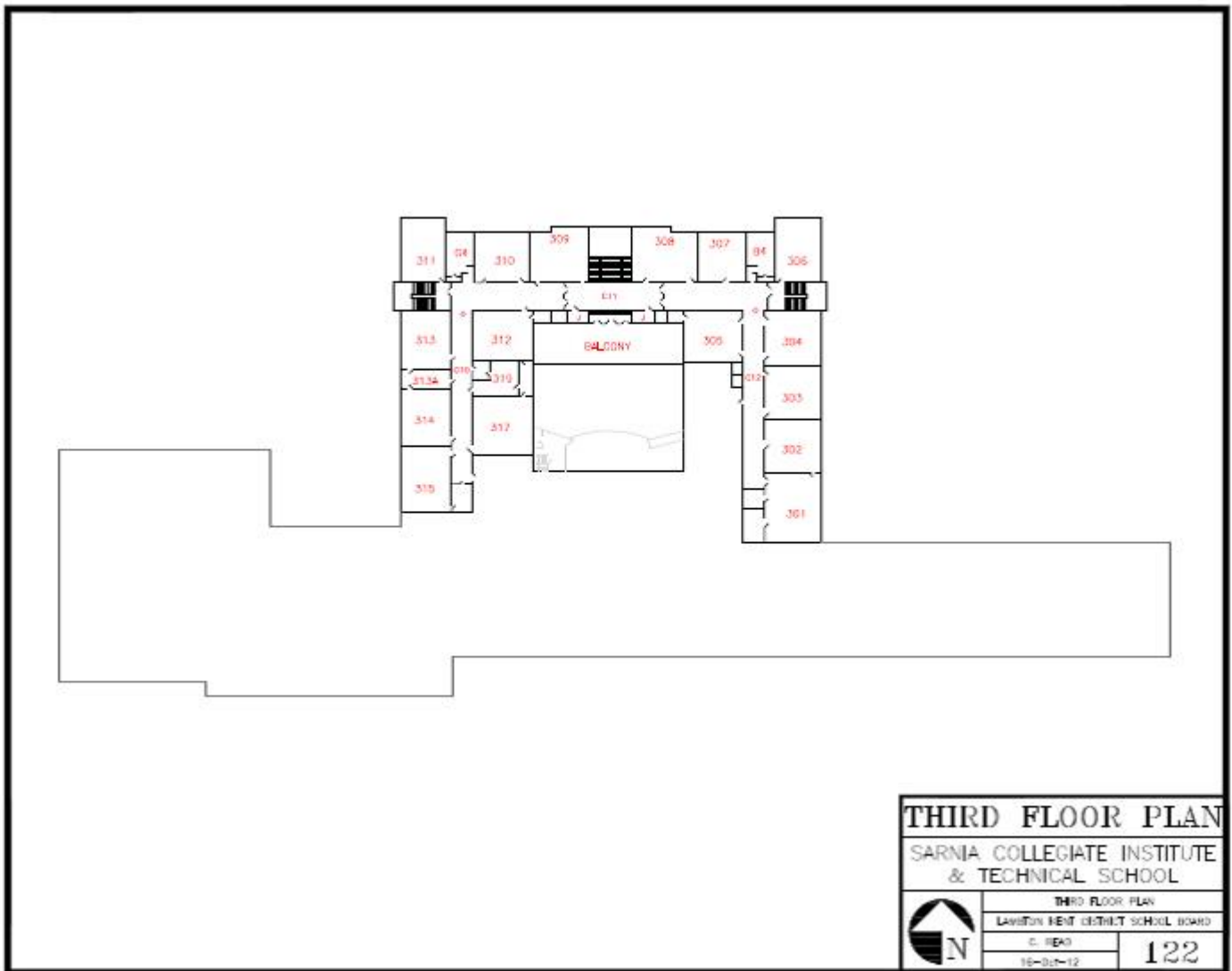

THIRD FLOOR PLAN	
SARNIA COLLEGIATE INSTITUTE & TECHNICAL SCHOOL	
	THIRD FLOOR PLAN
	LAMBTON KENT DISTRICT SCHOOL BOARD
	C. READ
	122
	16-02-12

SCHOOL INFORMATION PROFILE

Name of School: SCITS

Updated: 2016 03 31

Page 13

Satellite View

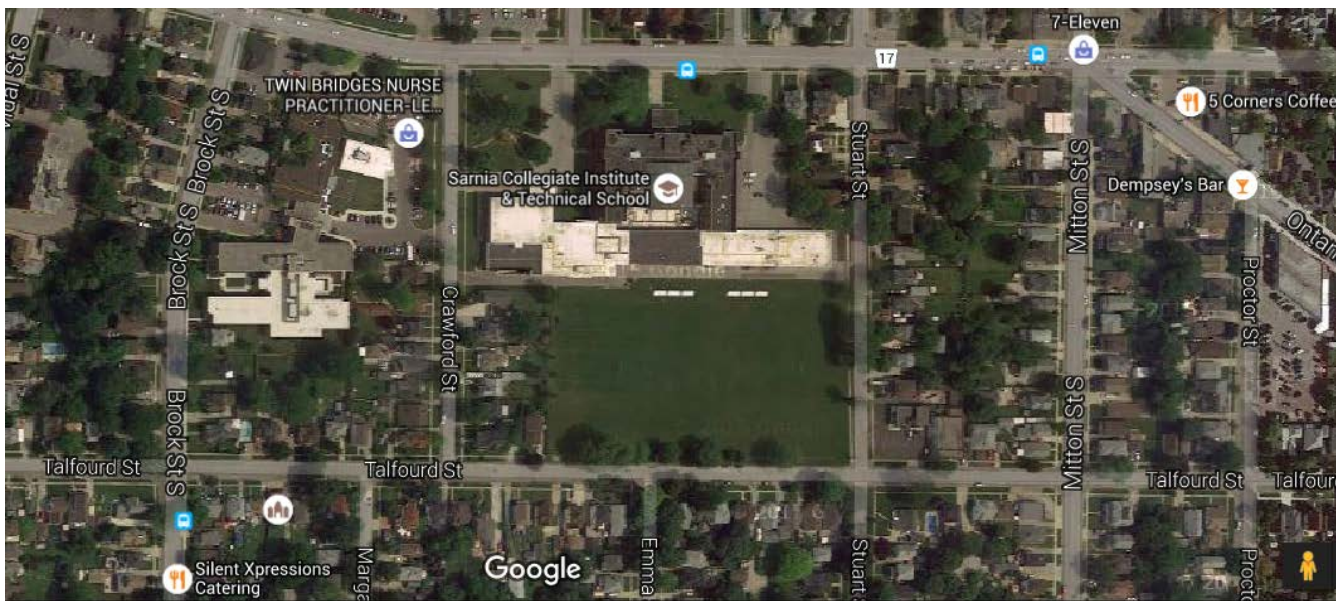

SCHOOL INFORMATION PROFILE

Name of School: SCITS

Updated: 2016 03 31

Page 14

Sarnia Collegiate Institute & Technical School

5 Year Enrolment History

Grade	2010	2011	2012	2013	2014
9	161	139	138	119	112
10	202	175	139	144	116
11	166	224	166	149	154
12	235	242	280	231	164
ALLP	5	8	10	10	10
Total	769	788	733	653	556

Enrolment Actual – October 31, 2015

Year	9	10	11	12	ALLP	Total
2015	148	113	118	183	8	570

10 Year Enrolment Projections

Grade	2016	2017	2018	2019	2020	2021	2022	2023	2024	2025
9	106	104	113	109	111	103	104	106	104	90
10	122	109	107	116	112	114	106	107	109	108
11	122	130	117	116	124	121	122	115	115	117
12	155	154	163	148	148	156	154	155	145	148
SCSE	10	10	10	10	10	10	10	10	10	10
Total	515	507	510	499	505	504	496	493	483	473

SCHOOL INFORMATION PROFILE

Name of School: SCITS

Updated: 2016 03 31

Page 15



SCHOOL INFORMATION PROFILE

Name of School: SCITS

Updated: 2016 03 31

Page 16

Updated from the information presented at the ARC Working Meeting #2 March 21, 2016.

Sarnia Renewal by Discipline

	2015	2016	2017	2018	2019	Total
B SHELL	\$876,077	\$0	\$0	\$0	\$269,912	\$1,145,990
C INTERIORS	\$926,126	\$0	\$0	\$0	\$1,449,108	\$2,375,234
D SERVICES	\$3,341,374	\$49,608	\$209,456	\$727,584	\$4,037,420	\$8,365,443
F SPECIAL	\$0	\$0	\$0	\$0	\$0	
CONSTRUCTION & DEMOLITION						\$0
G BUILDING	\$204,275	\$0	\$0	\$0	\$3,075,039	\$3,279,313
SITWORK						
Total	\$5,347,853	\$49,608	\$209,456	\$727,584	\$8,831,479	\$15,165,980